

Typical Glazing Bar Details

HG57 LIGHT BAR

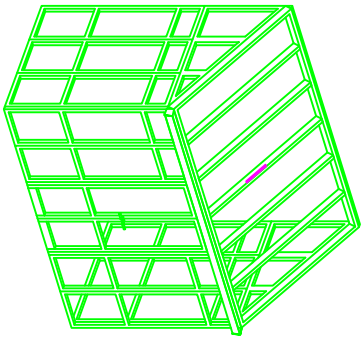

End Bar for Gable

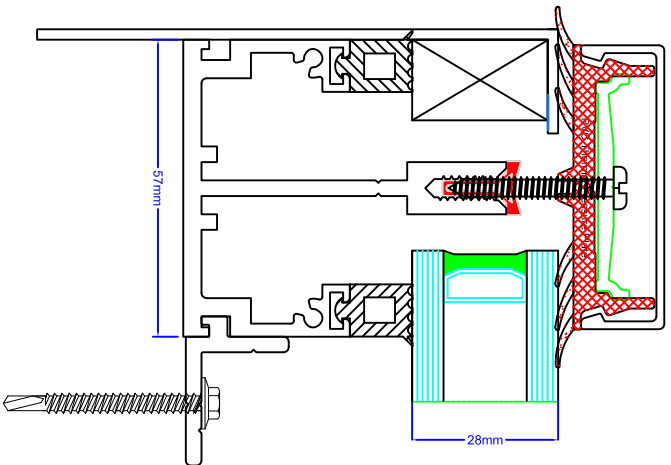

Centre Bar

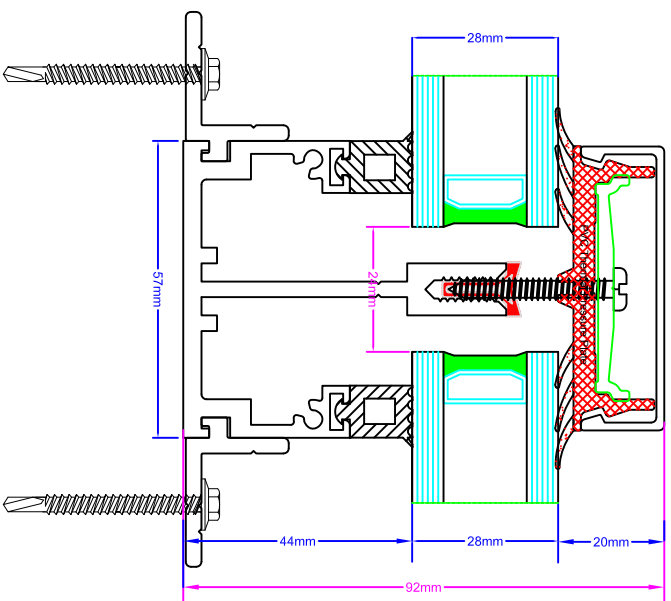

End Bar against wall

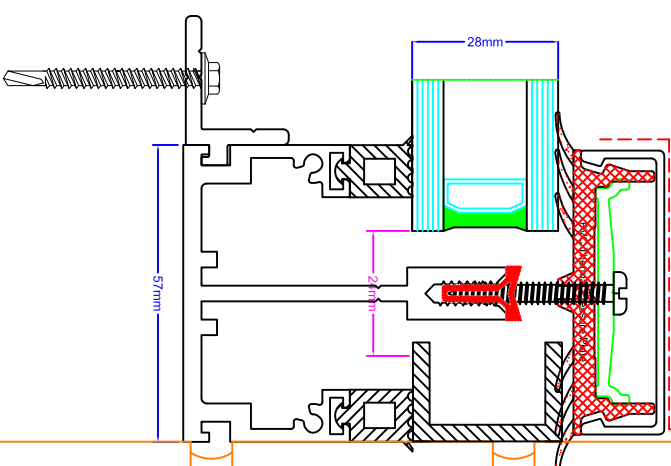

Lead Flashing

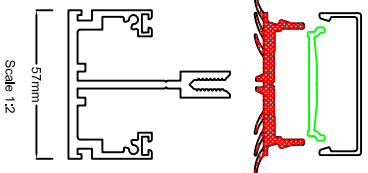

Typical Glazing Bar Details

HG57 LIGHT Bar

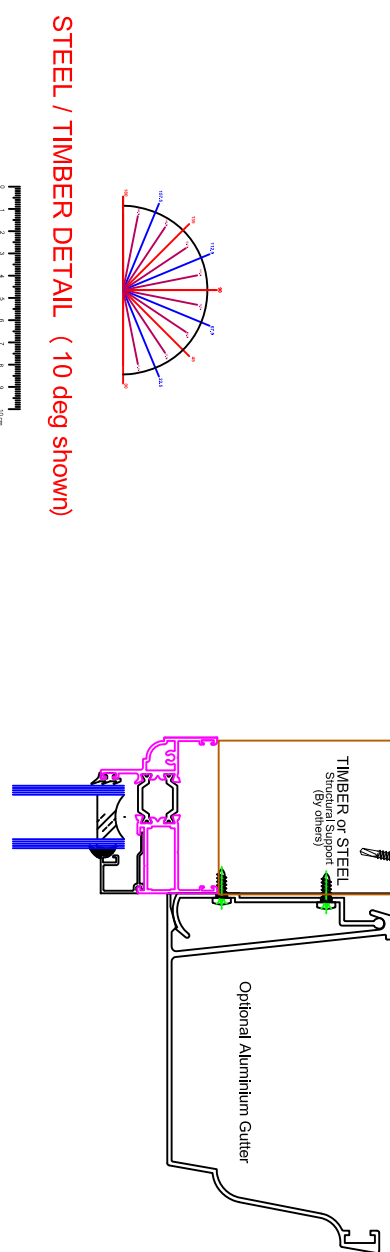
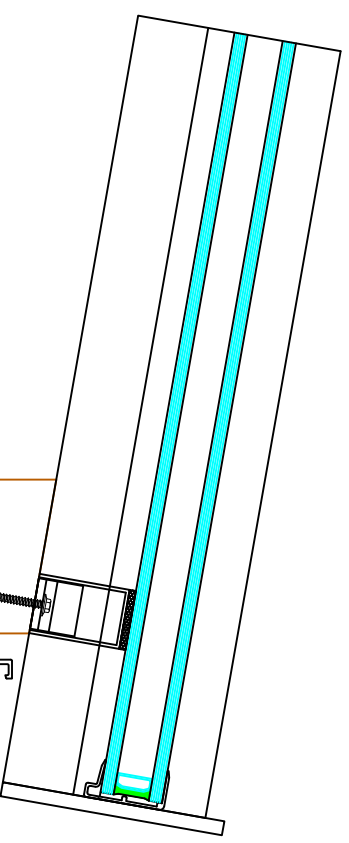
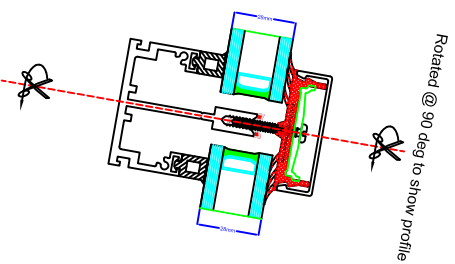
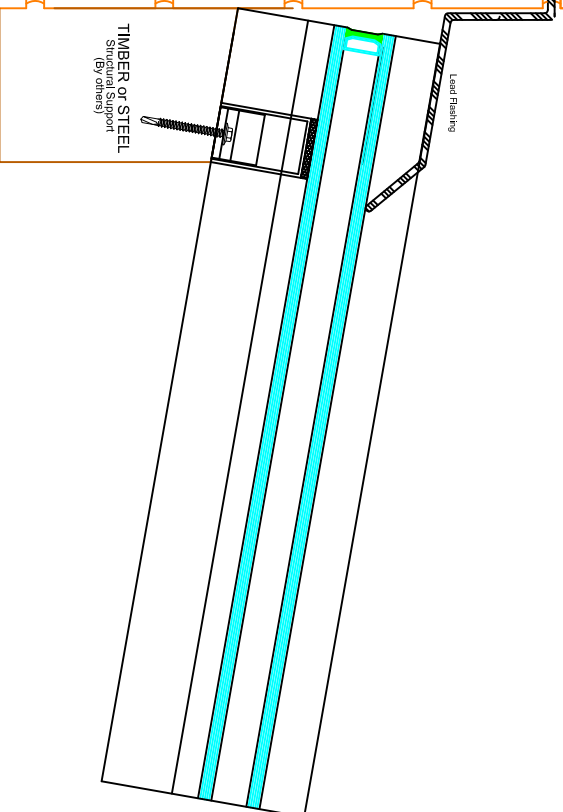
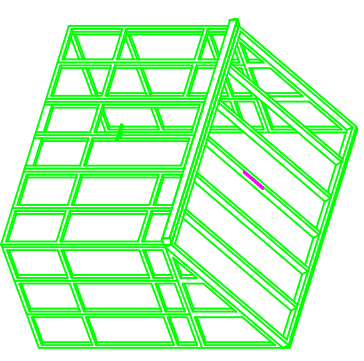

Typical Roof Vent

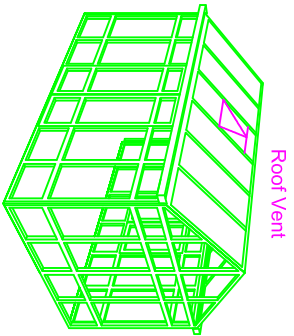

HG Thermally Broken Roof Vent Vent Assembly (Electric)

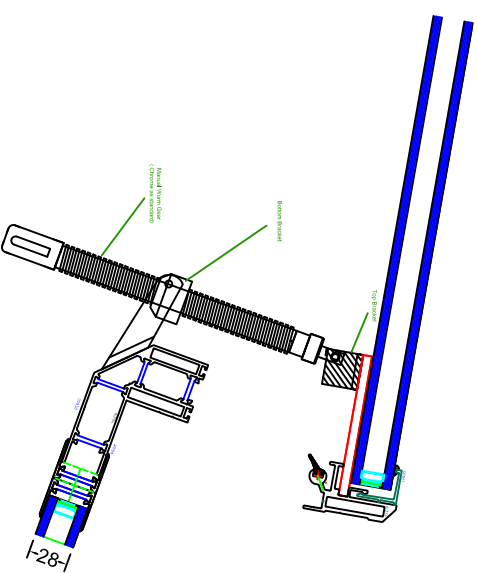
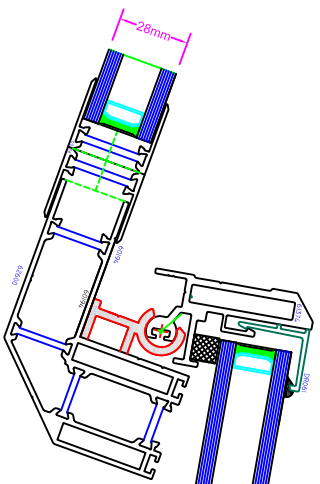

Manual Worm Gear Option

Aluminium Thermally Broken Polyamide Vent

- Manufactured to suit your exact sizes
 - Corners mechanically fixed with specialist UV Stabilized adhesive silicone
 - Can accept a multitude of glazing thicknesses (28mm as standard)
 - Powder Coated to any standard RAL or BS Colour of your choice.
- Please note roof vents over 1000mm width may require slave drive (i.e double motors or slave gear)

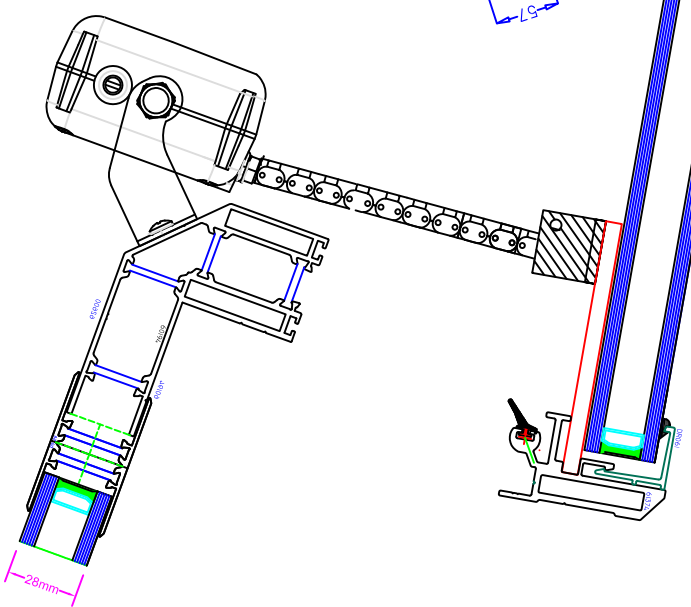
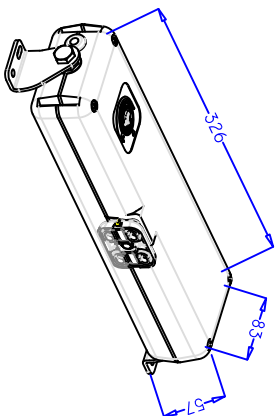

Typical Roof Vent

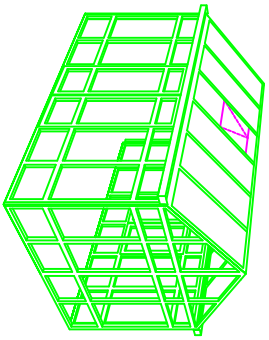

HG Thermally Broken Roof Vent Vent Assembly

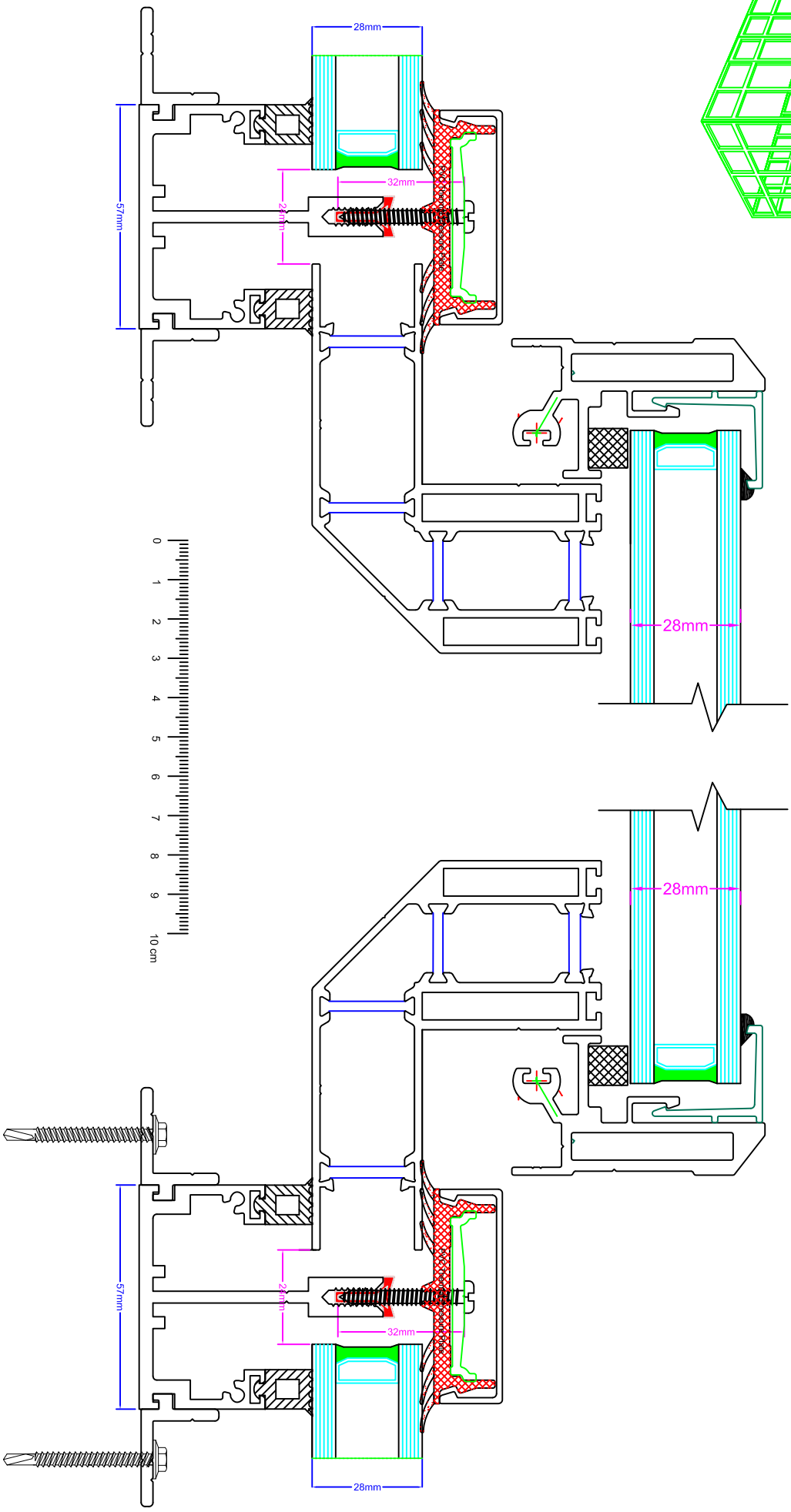

Typical Ridge Detail

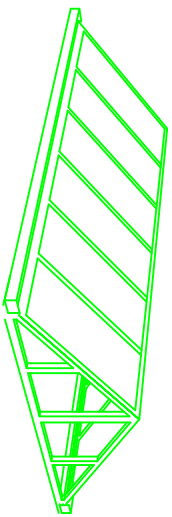

HG Thermally Broken Roof Vent Ridge Assembly

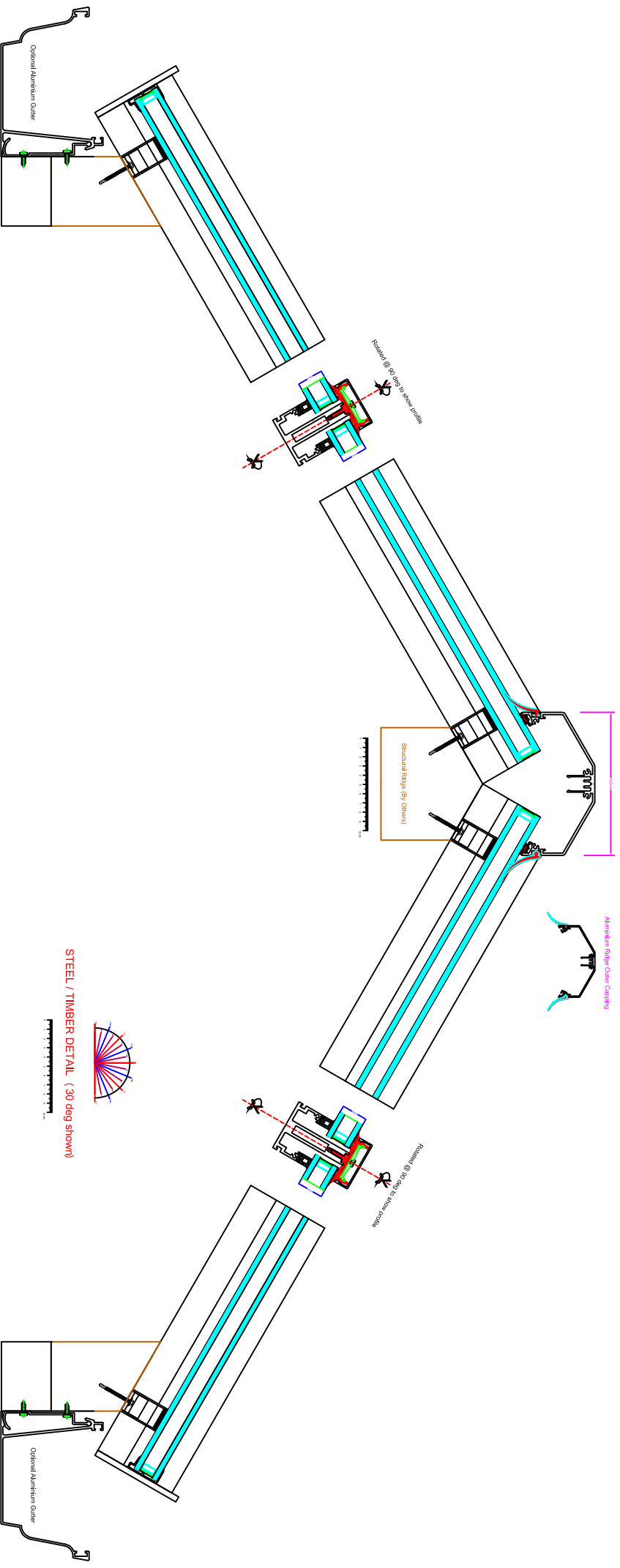

STEEL / TIMBER DETAIL (30 deg shown)

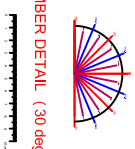

Typical Ridge Detail

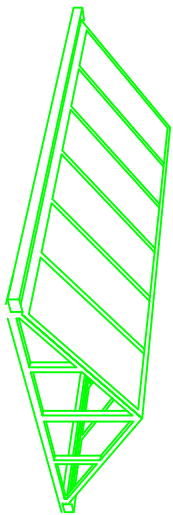

HG Thermally Broken Roof Vent Ridge Assembly

155mm

Aluminium Ridge Outer Capping

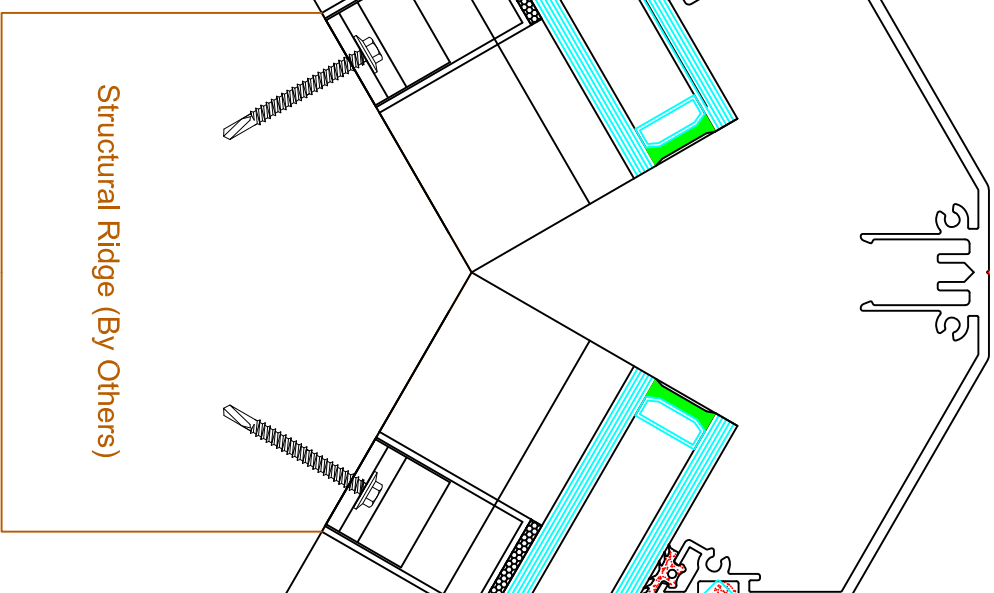
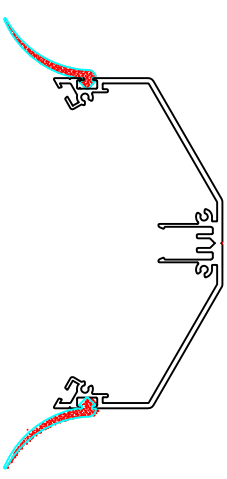

Structural Ridge (By Others)



REF 906 - 03.12.08